



## Warnings

In case of mold on the walls, before buying and installing a UNIDRY system, it is advisable to check that the mold is caused by **condensation** and not by rising water.

To measure the amount of water inside the walls, it is recommended to use a hygrometer.

In any case, installation must be carried out by **specialized workers**, strictly following the instructions for use.

## Recommended equipment

Biocide, sponge, wire brush, scraper, cement mixer, bucket, roller brush, wood saw, 8mm and 3mm notched trowel, glass paper, sponge trowel.

## Preparation of the walls

1. Wear **masks**, suits and overshoes before starting the preparation of the walls. Ventilate the room as much as possible and do not consume food or drinks.
2. Spray a good **biocide** and wait a few minutes.
3. **Remove mold** with a damp sponge.  
Do not use brushes or brooms on the dry wall in order to avoid to spread the spores.
4. **Scrape** the peeling or deteriorated areas of the plaster with a wire brush or scraper.
5. In the case of **gypsum plasters**, the surface paint layer must be removed, any swellings caused by humidity must be tapped and the surface obtained should be treated with an acrylic-based primer.

## Product Yield

1. **UNIDRY Smoothing Glue:** 1,2 kg / m<sup>2</sup> / mm  
You need approx 4 to 8 mm of thickness for glueing the panels.  
The finishing of the slabs requires approximately 3/4 mm of thickness  
OVERALL PRODUCT YIELD: from 8,4 to 14,4 kg per m<sup>2</sup>.
2. **UNIDRY Primer:** 0,45 l / m<sup>2</sup>  
Both the sides of the slabs must be treated before glueing or smoothing them.  
OVERALL PRODUCT YIELD: 0,90 l per m<sup>2</sup>.
3. **UNIDRY Pittura:** 0,35 l / m<sup>2</sup>  
OVERALL PRODUCT YIELD: 0,7 per m<sup>2</sup> (two coats of paint)



## Installing UNIDRY system



1. Pour 25 kg of UNIDRY Smoothing Glue and 9 liters of water into a bucket. Mix with a mixer until a soft and homogeneous mixture is obtained. It will remain workable for about 3 hours.



2. Cut or shape UNIDRY Panel, with a hacksaw or a cutter, to adapt its dimensions to the wall on which it will be glued. Treat the back side of UNIDRY Panel (the one with the shot in relief) with UNIDRY Primer, by spray or by roller.

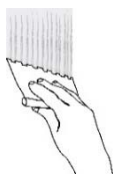

3. Spread the glue on the wall with the 8 mm notched trowel. If the wall surface is smooth, a 4mm thick layer will be enough, otherwise, it is recommended to spread a second 4mm thick layer on the back side of the panel.



4. Strongly press the panel against the wall to ensure that the glue spreads evenly, adjusting the vertical inclination of the panel. Keep 8mm of distance between the slabs and the floor.





- 5.** Add a small amount of glue on the edge of the slabs before placing them close to each other so that there are no empty spaces between the slabs. Press the slabs not to leave joints larger than 3 mm and promptly remove excess glue before it dries.



We recommend laying the panels horizontally with staggered joints between the courses, to avoid cross joints.



- 6.** Repeat the procedure described at points from 2 to 5 to fix the ceiling wedges.

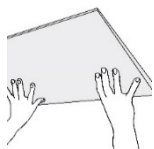

The installation of panels and ceiling wedges does not require the use of expansion screws which could create thermal bridges.



## Finitura dei pannelli

- 7.** For the reinforced smoothing of UNIDRY panels, in standard climatic conditions, wait at least 4-5 hours after gluing. Treat the front side of UNIDRY Panel with UNIDRY Primer, by spray or roller.

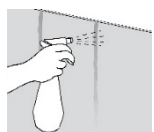

- 8.** Apply UNIDRY Smoothing Glue with a 3mm notched trowel and apply the fiberglass mesh. The net sheets must overlap by at least 10 cm.

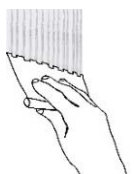

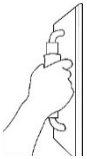

9. Spread a second layer of UNIDRY Smoothing Glue to completely cover the mesh and smooth with a sponge float.



10. After the complete drying of the walls, you can sand them to obtain a smooth and homogeneous surface. Then apply two coats of UNIDRY Paint.



### Suggestions

1. You can use small wood square blocks and longer screws to fix the **roll blinds** springs to the wall.
2. You can extend outward the recessed **electric boxes** using common extension accessories.
3. To hang **shelves**, **pictures** or **lamps**, depending on their weight, you can use nylon wall plugs for drywall linings or traditional nylon plugs long enough to anchor to the underlying wall.

